

Temassız Magnetostriktif Pozisyon Sensörü

- 100 - 900 mm ölçme boyu
- 16 bit çözünürlük
- 0-10V çıkış
- 24 VDC besleme



Teknik Özellikler

| | |
|--------------------------|----------------|
| Ölçme boyu | 100 ... 900 mm |
| Çözünürlük | 16 bit |
| Tekrarlanabilirlik | < 0.05 mm |
| Çıkış | 0-10V |
| Güç kaynağı | 24 VDC ±10% |
| Maksimum besleme voltajı | 30 VDC max. |
| Hız | < 10 m/s |
| Örnekleme | 1 Khz |
| Maksimum tüketim | 50mA |
| Maksimum çıkış gürültüsü | < 5mVpp |
| Maksimum çıkış değeri | 10.5 Volt |

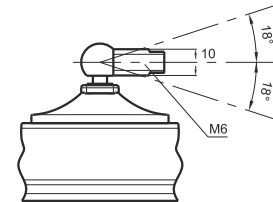
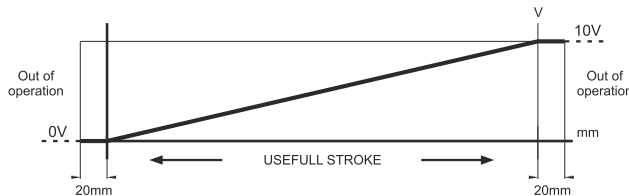
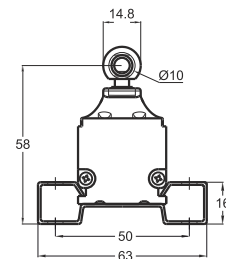
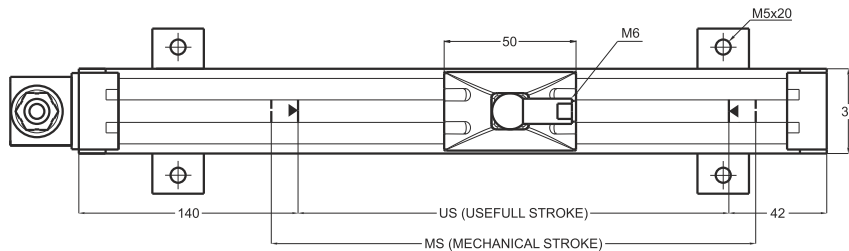
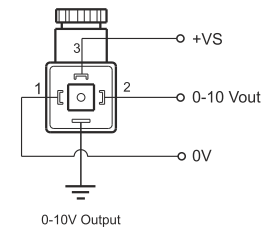
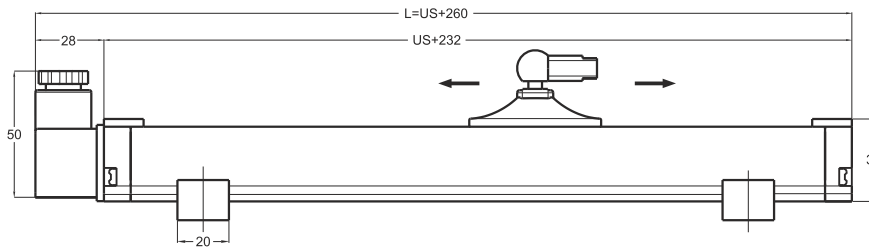

| | | | | | | | | | | | | | | | | | |
|------------------------|-----|-----|-----|-----|-----|-----|-----|-----|-----|-----|-----|-----|-----|------|------|------|------|
| MSH (mm) | 100 | 150 | 200 | 250 | 300 | 350 | 400 | 450 | 500 | 550 | 600 | 650 | 700 | 750 | 800 | 850 | 900 |
| US (Usefull Stroke) | 150 | 200 | 250 | 300 | 350 | 400 | 450 | 500 | 550 | 600 | 650 | 700 | 750 | 800 | 850 | 900 | 950 |
| MS (Mechanical Stroke) | 190 | 240 | 290 | 340 | 390 | 440 | 490 | 540 | 590 | 640 | 690 | 740 | 790 | 840 | 890 | 940 | 990 |
| L (Total Length) | 360 | 410 | 460 | 510 | 560 | 610 | 660 | 710 | 760 | 810 | 860 | 910 | 960 | 1010 | 1060 | 1110 | 1160 |

| Model | Ölçme boyu | Çözünürlük | Çıkış | Konnektör / Kablo |
|-------------|---------------|------------|-------------|------------------------|
| (örnek) MSH | 300 | A | V10 | C1 |
| MSH | 100 ... 900mm | A : 16 bit | V10 : 0-10V | C1 : 4 pinli konnektör |